

PRODUCT

AIM High Impact Soffit Liner Boards offer excellent impact resistance and are used to provide an insulated lining to semi exposed soffits. They can also be used as internal linings for walls and ceilings, especially where robustness is required.

They are available with a choice of insulation backing boards, typically Stonewool or rigid foams such as phenolic, PIR or XPS.

The fibre cement facing board can be easily decorated to match design and colour schemes.

Pre-decorated and through coloured facing boards are available.

APPLICATIONS

Suitable for use with concrete soffits where a thermal performance is required.

FEATURES

- Choice of insulation materials available (Stone Wool / Phenolic / PIR / XPS)
- 6mm High impact facing boards
- Non standard sizes also available.
- Pre-decorated and through coloured facing boards are available.

BENEFITS

- Can help achieve thermal performance of the construction.
- Thicknesses to suit the thermal resistance (U Value) required.
- Choice of insulation materials to suit the thermal resistance required.
- Provides protection to the underside of soffits, especially in car parks.
- Mineral fibre backed boards can contribute to the overall acoustic performance of the soffit / floor construction.

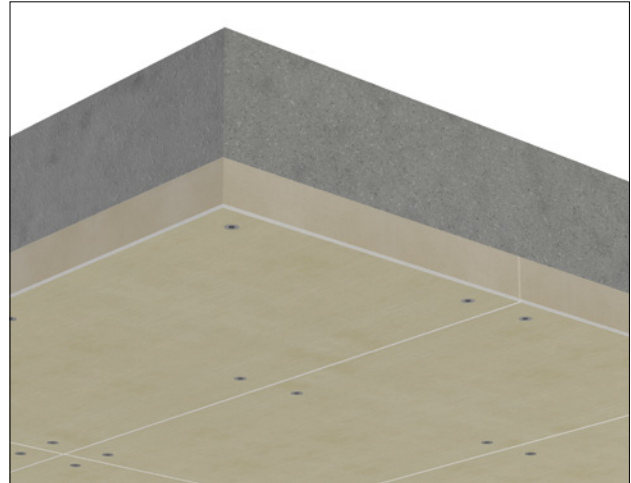

Example product installation schematic using materials by others

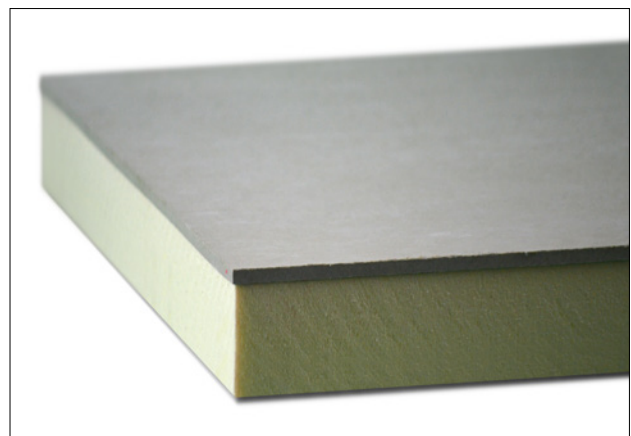
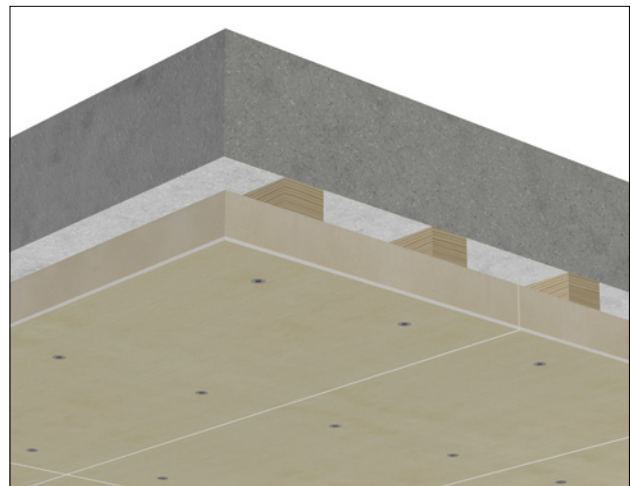

PHYSICAL INFORMATION

- Manufactured from an insulation slab bonded to fibre cement board.
- Suitable for exposed and semi exposed applications dependant on the insulation material used.

High Impact rigid cement board facing:

- 6mm thick.
 - Choice of 1200 x 600mm or 2400 x 1200mm boards.
 - Special sizes available on request.
 - Cement Board in conformance with EN 12467.
 - Euroclass A1 Non-combustible to EN 13501-1.
 - Fully external grade / frost resistant.
- AIM High Impact Soffit Liner Boards are supplied stretch wrapped onto pallets with a showerproof polythene pallet cover and edge protection.

Available faced with UHD decorative rock fibre board, suitable for fully exposed exterior cladding applications.

Choice of thermal and acoustic insulation:

Compression Resistant Rockfibre (CRR) - High density, high compressive strength, acoustic grade resilient rock fibre insulation slab.

Extruded Polystyrene (XPS) - Small closed cell extruded polystyrene for optimum insulation, high compressive strength and resistance to moisture.

Expanded Polystyrene (EPS) - Versatile expanded polystyrene for optimum value and light weight.

PIR - Low thermal conductivity for thinner solutions.

Phenolic (PHN) - Phenolic foam has very low thermal conductivity.

Decoration

The facing of AIM High Impact Soffit Liner Boards can be painted without any special priming using an alkali resistant paint or emulsion. Two coats of paint will usually give a satisfactory finish.

AS STANDARD

All AIM High Impact Soffit Liner Boards are made to order.

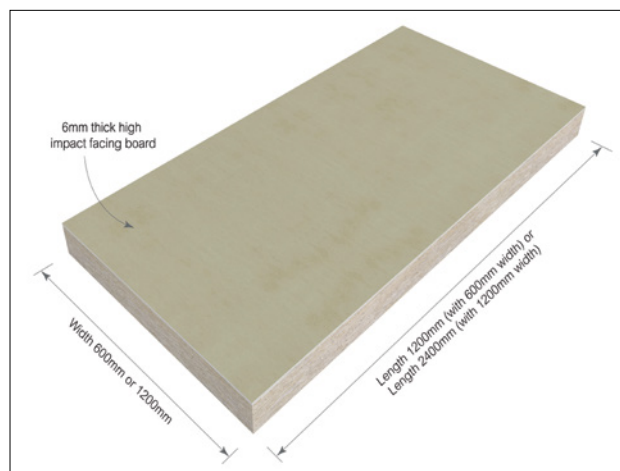

OPTIONS

AIM A2 High Impact Soffit Liner Boards offer a limited combustibility option classified as A2-s1,d0 in accordance with BS EN 13501-1. See the AIM website for further details.

AIM are able to manufacture insulation building boards with tissue or foil facings for soffit applications that do not require a high impact board finish. Please contact our sales office for further details.

TEST REPORTS

There is no European harmonised standard or British standard covering the manufacture, performance and specification of insulated fibre cement boards.

The base insulation used is manufactured to the relevant standard for the product.

The Fibre Cement board is manufactured to EN 12467.

Acoustic testing is covered by Z11012 – Acoustic Performance BS EN ISO 10140-2.

Please contact us for further details if required.



AIM are partners with NBS. Our products can be found on NBS Source and have been authored to NBS specification standards and have both CAWS and Uniclass 2015 classifications.

TECHNICAL INFORMATION

Thermal Performance

AIM High Impact Soffit Liner Boards are available in a variety of insulation boards to match the thermal resistance required for the specification.

Specific thermal resistance details of the insulation materials varies according to the type and brand of insulation used. Precise details can be given on request.

U Value calculations for the project can be undertaken upon request.

Acoustic Performance

Mineral fibre backed boards can contribute to the overall acoustic performance of the soffit / floor construction.

In testing a 136mm thick, stone wool back High Impact Soffit liner board achieved a 34dB R_w reduction in sound transmission. Please contact AIM for further details.

Items required for installation



PPE abrasion resistant gloves



PPE impact resistant goggles



RPE dust mask - FFP3



Drill



Screwdriver



Tape measure



Skill Saw and TCT blade

INSTALLATION GUIDELINES

AIM High Impact Soffit Liner Boards may be fixed directly to concrete soffit using suitable steel fasteners; the fixings supplier should be contacted for advice prior to installation, especially if a hard concrete has been specified.

Alternatively treated timber battens can be fixed to the concrete first and the AIM High Impact Soffit Liner Boards then fixed to the battens. The battens should be fixed at 300mm centres for Compression Resistant Rockfibre or 400mm centres for XPS, Phenolic and EPS, running down the length. The battens must provide at least 75mm bearing.

The Units are mechanically fixed to the battens by corrosion resistant fixings. The screws should be a pan head fixing installed with a controllable speed screw gun and not overdriven, to prevent undue compression of the insulation backing. We suggest avoiding any counter sunk fixings and hammer fixings. Please contact the sales office for more details.

Fixings are set in at least 50mm from the board edges, at the four corners of the board and at 600mm maximum centres.

Where the AIM High Impact Soffit Liner Boards are being attached to a framed backing, such as in the situation where they are being used to form a soffit under a trussed eave overhang, the framing must allow fixings at the centres specified above. Where this is not possible, or where there are problems with level alignment, a sub framing system needs to be used.

If the relative humidity of the area being lined is subject to significant variation, expansion gaps should be left between the boards to accommodate possible movement.

It may be possible to adopt a different fixing pattern dependent on the type of fixings used and the substrate in which the fixing is to be secured. Please seek advice from your nominated fixing supplier.

Where the AIM High Impact Soffit Liner Boards need to be cut to size, a skill saw fitted with TCT blade and suitable dust extraction should be used along with the appropriate personal protective equipment.

Fixing layout for 1200mm x 600mm AIM High Impact Soffit Liner Boards

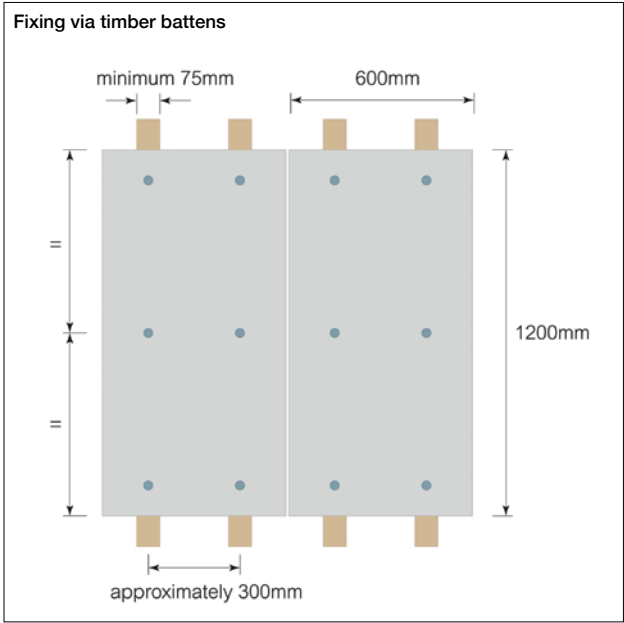
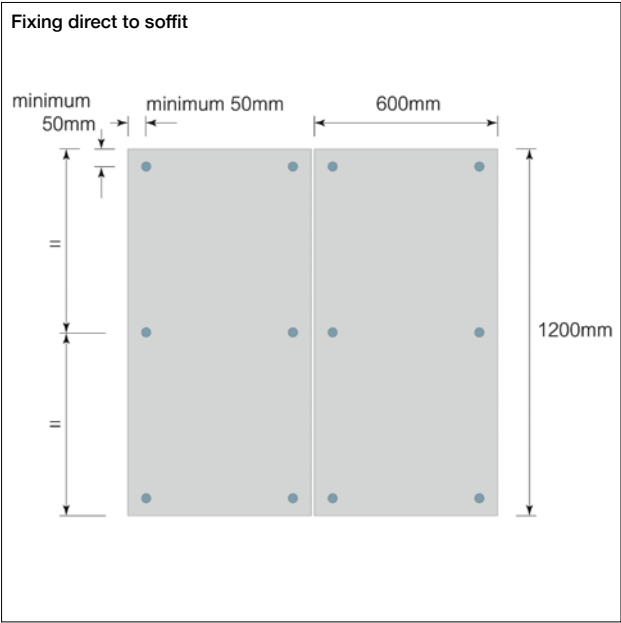

Fixing layout for 2400mm x 1200mm AIM High Impact Soffit Liner Boards

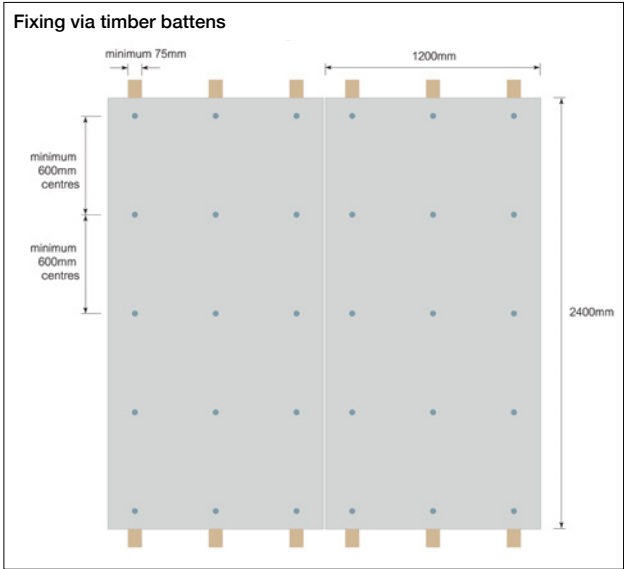
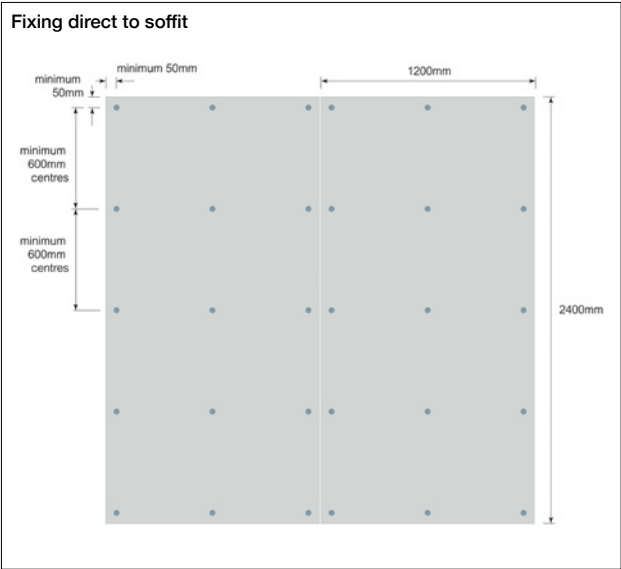

STORAGE

Products are supplied on wooden pallets with edge protection and a shower proof hood. Products should be stored away from the elements until ready for installation.

MAINTENANCE

This product does not contain moving parts and, if undisturbed requires no routine inspections or maintenance.

DURABILITY

AIM High Impact Soffit Liner Boards are chemically inert, will not sustain vermin and do not encourage the growth of rot, fungi, moulds or bacteria. They are compatible with all normal building materials. They do not degrade under the usual conditions found in buildings and will perform effectively for the life of the building.

HEALTH & SAFETY

The Facing Board contains crystalline silica which may be released when dry working (cutting / drilling).

The insulation boards used to make AIM Soffit Liner Boards are considered to be inert articles.

Product Safety and Handling Information Sheets are available covering the various insulants and facing board used.

ENVIRONMENT

Global warming potential = zero

AIM High Impact Soffit Liner Boards are manufactured from a variety of insulation materials.

For product recycling of stone wool based variants, please contact: Rockwool T: 01656 868400
E: recycling@rockwool.co.uk where the insulation used is Rockwool stone wool.

ORDERING

To order this product the following information will be required:

- Insulation board preferred.
- Insulation thickness or thermal resistance required.
- Board dimensions.
- Approximate quantity.
- Delivery location.

All AIM products are made to order. Products are typically supplied in seven to ten working days but lead times may vary depending on existing factory commitments.

There is no minimum order quantity or value although small orders may attract transport surcharges.

TECHNICAL SUPPORT

Technical Support is available from our experienced sales team on 01293 582 400 or sales@aimlimited.co.uk

ABOUT AIM

AIM are a quality insulation convertor with over 30 years experience in the design, testing & manufacturing of high quality fire barriers for customers worldwide.

VERSION CONTROL

Issue 2 - 04 2025

This document replaces and supersedes all previous versions.

The current version number can be verified at <https://www.aimlimited.co.uk/downloads/> or call AIM on 01293 582400